



**KODIAK  
CONTROLS®  
INC.**

# KC101 Series Pressure Gauge

Kodiak's 100 series pressure gauges are an inexpensive utility gauge for commercial and industrial applications. This series gauge is commonly used on air, water, oil, or gas applications that are compatible with brass/bronze and on applications without excessive vibration or pulsations.

## Specifications

**Dial Sizes:** 1.5", 2", 2.5", 3.5"  
**Case:** Black Painted Steel  
**Wetted Parts:** Brass/Bronze  
**Bezel:** Crimped with Chrome Plating  
**Lens:** Polycarbonate  
**Pointer:** Black Aluminum  
**Connection:** Lower Mount  
 1.5" Dial - 1/8" NPT  
 2" Dial - 1/8" or 1/4" NPT  
 2.5" Dial - 1/4" NPT  
 3.5" Dial - 1/4" NPT  
**Scale:** Standard: PSI/BAR (x100 = kPa)  
**Accuracy:** 3-2-3%  
**Dry Non-Fillable**  
**Temperature:** -40°F/160°F

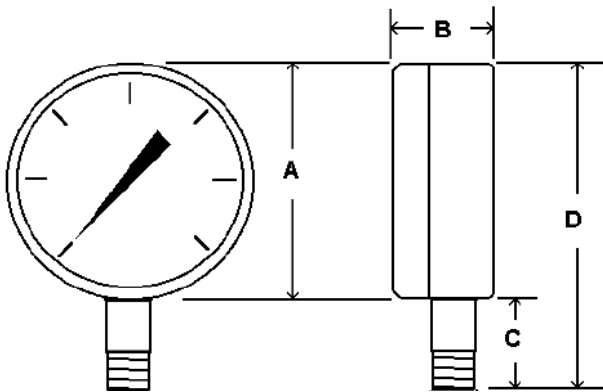

	Unit	A	B	C	D
1.5" Dial	IN	1.64	0.93	0.63	2.27
	MM	42	24	16	58
2" Dial	IN	2.07	1.03	0.83	2.90
	MM	53	26	21	74
2.5" Dial	IN	2.50	1.17	0.86	3.36
	MM	63	30	22	26
3.5" Dial	IN	3.53	1.14	1.02	4.55
	MM	90	29	26	116

## Options\*

- Custom Dials
- Special Connection Threads (BSP, SAE, etc.)
- Glass Lens
- NIST Certificates of Calibration

\*Lead times and minimum orders may apply

Example:

KC101 20 160

Dial Size:  
 15 = 1.5"  
 20 = 2"  
 25 = 2.5"  
 35 = 3.5"

Thread Size:  
 8 = 1/8" NPT  
 Blank = 1/4" NPT

Ranges:

15 psi      1000 psi  
 30 psi      30"Hg Vac  
 60 psi      30"Hg/15 psi  
 100 psi     30"Hg/30 psi  
 160 psi     30"Hg/60 psi  
 200 psi     30"Hg/100 psi  
 300 psi     30"Hg/150 psi  
 400 psi     30"Hg/300 psi  
 600 psi